

1x10 imagic® E9910

Product range



Egg sizes

Our E 9910 egg cell is constructed for weight classes S, M, L

Product dimensions (closed)

Width: 105 mm
 Height: 69 mm
 Length: 246 mm

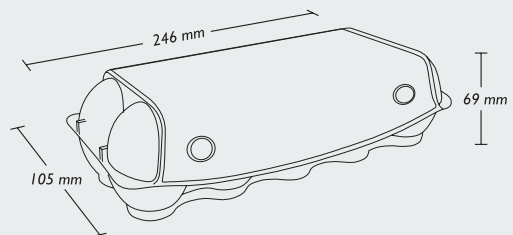

Colours

Standard colours

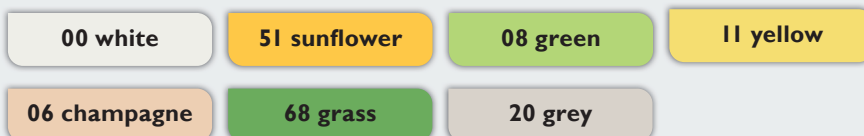

1x10 imagic® E9910

Average product weight

With label: 45.6 g
 With direct print: 42.7 g

Quantities

Pallet:	44 EURO	79C one way UK
Units per bundle:	56	62
Units per pallet:	3,920	4,464

Machine settings

Moba Code: HAI002

Gripper Set No.: 900
 Denester Settings

L	G	J	II	I2
15	12	26	13	36

Sanovo Code (Staalkat): HA-034

Disclaimer

Please consult MOBA and SANOVO for confirmation of the machine settings

Decorations

Label: 4-colour label.
 Spot colours on request

Direct print: Top: 6-colour.
 Front and rear: 4-colour

Inlid print: 1-colour: black

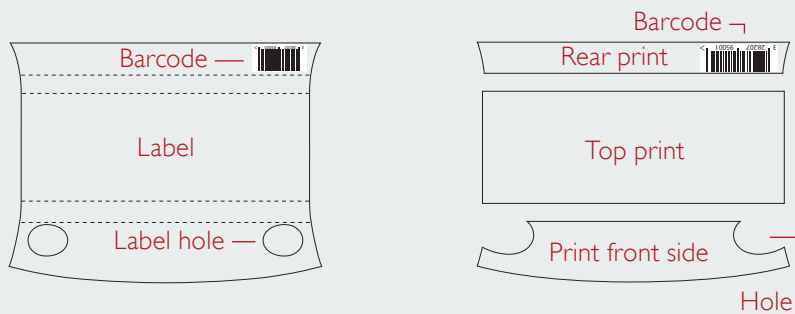

Modules for labels and print areas can be downloaded at www.hartmann-packaging.com

Certifications (optional)

